

# DURHAM-DUPLEX

**SHEFFIELD - ENGLAND**

*Razor sharp since 1910*

## VACUUM PACK AND THERMOFORM

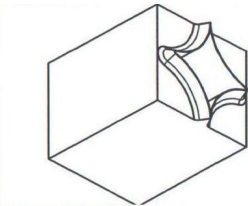
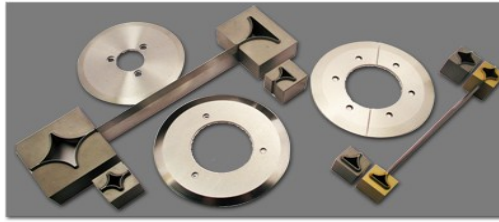
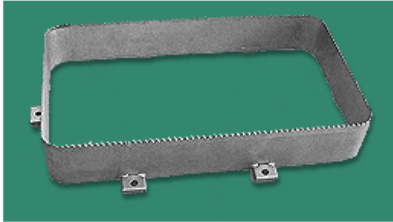

2SP2 01MF 005

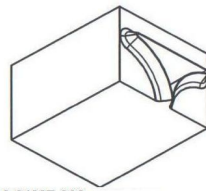
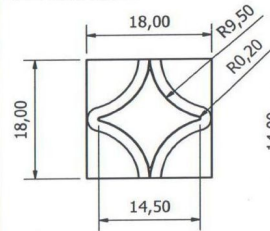

2SP2 01MF 002

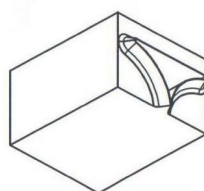
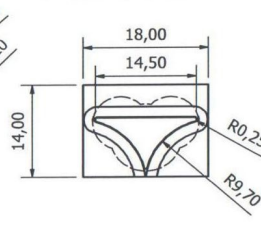

AS 002 BUT TRIANGLE BACK

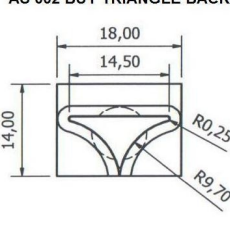

All punches are manufactured in High Carbon High Chrome premium grade corrosion resistant tool steel.

Straight bars are available in Carbon steel, M2 High Speed Steel and Solid Tungsten Carbide

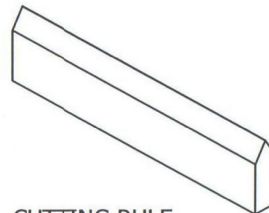

CUTTING RULE  
0.7, 3.00 OR 4mm 23.80mm HIGH

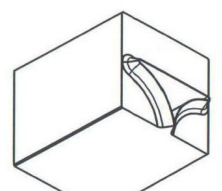

Non Standard

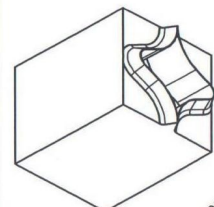
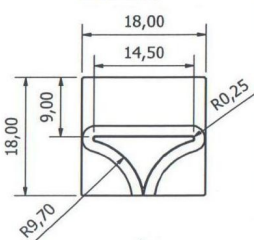

2SP2 01MF 014

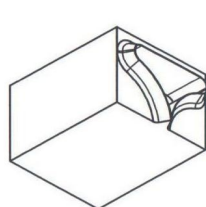
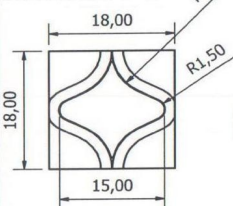

2SP2 01MF 015

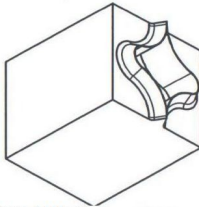
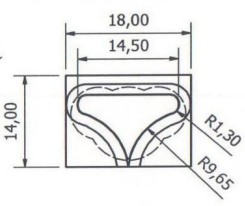

2SP2 01MF 013

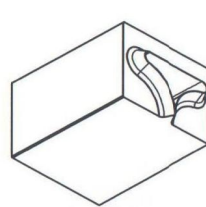
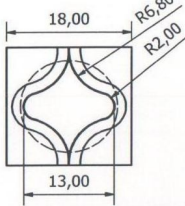

2SP2 01MF 012

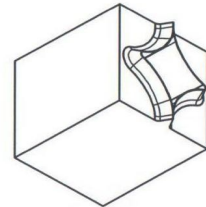
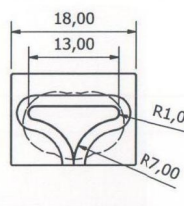

2SP2 01MF 020

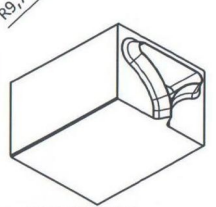
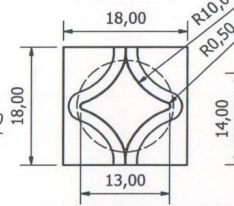

2SP2 01MF 021

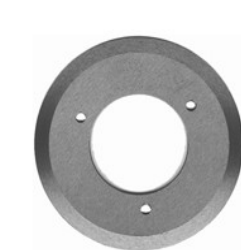
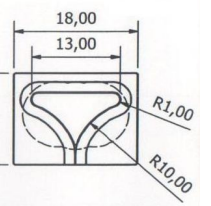

single and double bevel slitters

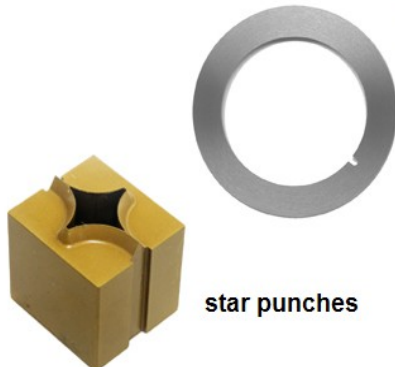

star punches

dish slitters

fly knives



3" Crush Wheels



Perf side slitters



65 x 1mm CFS cross cuts



40 x 1mm Multivac cross cuts